



RIDGE RACER V

TWIN AND UPRIGHT

TECHNICAL UPDATE

We have become aware that due to an error in the security card software on this equipment, operator-set game options such as game difficulty , high scores, etc., are resetting to factory default each time the game is switched off.

We would advise that the enclosed security cards are replaced immediately both to enable the game to function correctly and to maximise profitability.

These units have been sent as advance replacement parts under warranty and have been invoiced to you. They will be credited in full, including carriage, when they are returned.

- The security cards are designed for this game only. Do not use them with other models. Do not insert any other security cards as doing so will cause the equipment to malfunction.
- Always install one security card to each game pcb Assy. The deluxe version has two of the latter while the standard has one.

- 1 Remove the monitor cabinet lower rear door.
2. Remove the old security card by pulling it directly out from the game pcb Assy.

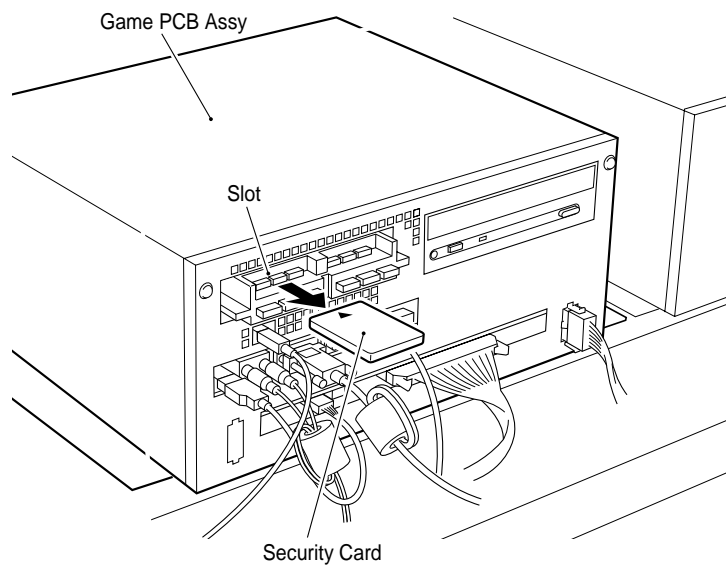

- 3 Insert the new security card with the arrow upwards into the left slot. Push the security card until it is fully connected to the slot connector.
4. Refit the rear door.

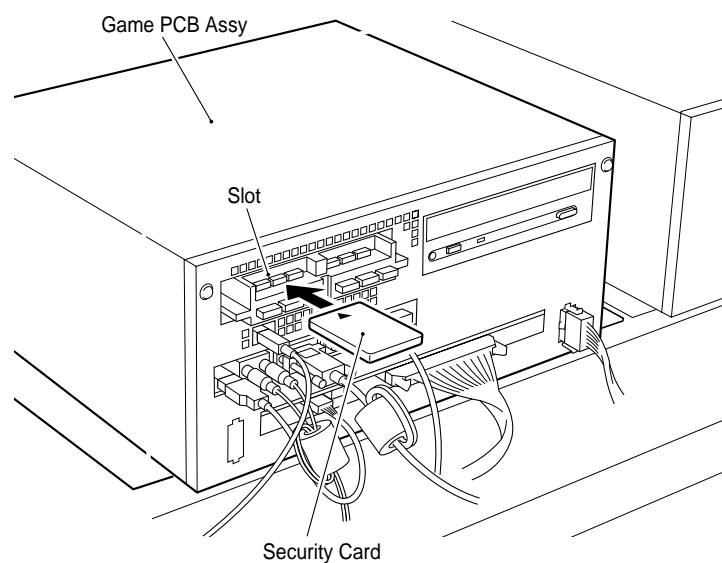

5. Set the game options to the required settings. (see section 6-3-2 game options in the operator's manual)